

Tree of Life Mantle Lamp

Creative Paradise Inc.

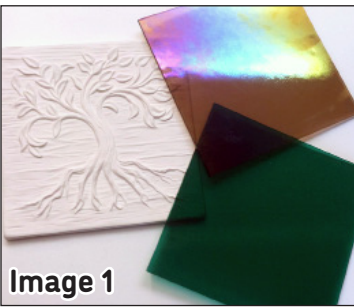

Image 1



Image 2

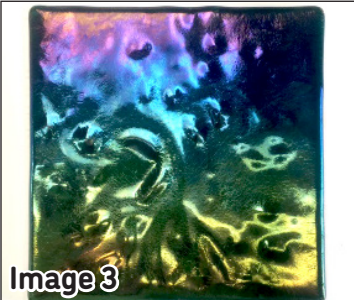

Image 3



Image 4

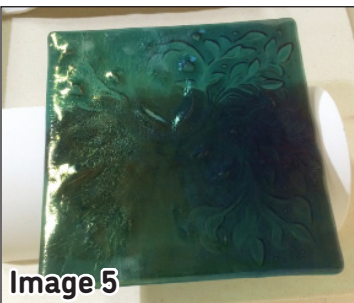

Image 5

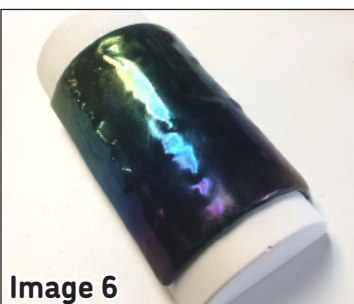

Image 6

Materials:

- [GX13 Small Tree of Life Texture](#)
- [GM30 Small Cylinder Drape](#)
- [LBGM30 Lamp Base Kit](#)
- [COE96 Sheet Glass:](#)
 - Teal Green Trans.
 - Iridized Bronze Trans.
- Suitable Glass Separator/ZYP
- Glass Cutting Tools
- See **Page 2** for Painting Supplies

Fusing:

Begin by treating the GX13 and GM30 molds well with suitable glass separator. We recommend spray-on ZYP. **If using spray-on separator, make sure to wear a mask during application.**

Cut and clean a 6.5" square of Teal Green Trans. and a 6.5" square of Iridized Bronze Trans. sheet glass (**Image 1**). Place the primed GX13 on a level shelf in the kiln and center the Teal Green square on top, then center the square of Bronze atop the Teal with the irid side facing up (**Image 2**). Fire using the suggested schedule in **Table 1** or your own preferred Full Fuse.

Allow the kiln to cool naturally. When you open the kiln the surface of the fused glass will be slightly textured (**Image 3**) and the Tree of Life embossed on the other side (**Image 4**). If there is any residual separator stuck to the glass, remove it with running water and a stiff (but not wire) brush.

Place the primed GM30 Drape on a level kiln shelf. Center the fused glass on the Drape, iridized surface up, with the tree lined up lengthwise with the center marks on the drape (**Image 5**). Fire using the suggested schedule in **Table 2** or your own favorite Draping schedule.

Allow the kiln to cool naturally then remove the draped glass from the mold (**Image 6**). Clean off any separator if necessary.



Example 1

Table 1: Full Fuse*

| Seg. | Rate | Temp (°F) | Hold |
|------|------|-----------|------|
| 1 | 275 | 1210 | 30 |
| 2 | 50 | 1250 | 20 |
| 3 | 275 | 1330 | 05 |
| 4 | 350 | 1460 | 05 |
| 5 | 9999 | 950** | 60 |
| 6 | 100 | 825 | 05 |
| 7 | 100 | 500 | 05 |

**If using COE90, adjust this to 900°F

Table 2: Drape*

| Seg. | Rate | Temp (°F) | Hold |
|------|------|-----------|------|
| 1 | 275 | 1210 | 20 |
| 2 | 50 | 1240 | 05 |
| 3 | 9999 | 950** | 60 |
| 4 | 100 | 825 | 05 |
| 5 | 100 | 500 | 00 |

**If using COE90, adjust this to 900°F

*Before firing, it's important to know your kiln to see if you need to adjust our suggested schedules. For tips on how to do that, [please click here to see our Important Firing Notes!](#)



Image 7

Painting and Assembling:

The GM30 Drape is designed to create pieces that fit on the LBG30 Lamp Base. The ceramic base can be glazed with a Cone 04 glaze then fired to glaze manufacturer's instructions or it can be coated with acrylics. This example uses acrylics to create a base complimentary to the glass.

For Base Painting:

- Acrylic Paints:
 - Teal
 - Copper
 - Blue
- Painting Supplies:
 - Water
 - Round Synthetic Sponge
 - Paint Dish or Palette

The base made for this tutorial (**Examples 1-3**) was painted with acrylic paints to create a faux copper patina finish. The three colors used here were Creative Paradise Acrylic colors 924 Teal, 973 Copper Penny, and 925 Medium Blue. While these acrylics have been discontinued, there are many others out there with similar shades! Any close shades of Teal, Copper, and Blue can be used to the same effect for this project.

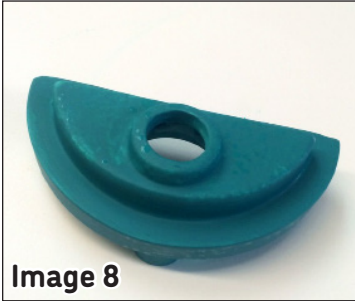

Image 8

Begin by moistening a round synthetic sponge. Dip the sponge into a bit of Teal and use it to base coat the entire surface of the Lamp Base, including the bottom (**Images 7 & 8**). Clean the sponge well then dip it into a bit of Copper and dab it here and there over the Teal base coat (**Image 9**). Allow it plenty of time to dry before continuing.



Image 9

Clean the sponge again and dip it into a bit of Blue. Dab it over both the Teal and Copper to finish the patina look (**Image 10**), then set aside for it to dry completely.

To assemble the Lamp Base, insert the metal socket through the bottom of the Lamp Base until the clip wings are braced securely in the bottom hole (**Image 11**) and the top of the socket is level with the top hole. Once the socket is secure, screw in the bulb.



Image 10

The fused glass portion of the lamp will rest on the ledge around the edge of the base. If your glass is uneven or wobbly, a few dots of E6000 or similar adhesive placed on the ledge can keep it in place (**Image 12**). Once the glass set and any adhesives have dried, place the lamp on a secure flat surface, plug in, and enjoy!



Image 11



Example 2

Example 2: The same lamp as **Example 1, Page 1**, with the bulb turned off.



Example 3

Example 3: The same lamp as **Example 1, Page 1**, with the bulb turned on again.



Image 12

Page 2

For more information, tutorials, and molds, visit our website:
www.creativeparadiseglass.com

Creative Paradise Inc.